



Flemings Farm Close , Runwell, SS11 7PJ Asking Price £350,000

** ONWARD CHAIN COMPLETE ** CALL TO ARRANGE A VIEWING **

Situated within the highly sought-after St Luke's development, this modern two-bedroom coach house on Flemings Farm Close offers stylish and low-maintenance living, ideal for first-time buyers, professionals, or investors.

The property features a bright and spacious open-plan lounge, kitchen, and dining area, thoughtfully designed for contemporary living. Double doors lead out onto a private balcony, providing the perfect space to relax or entertain while enjoying elevated views.

There are two well-proportioned bedrooms, offering comfortable accommodation, alongside a modern bathroom finished to a high standard. The layout maximises both space and natural light throughout.

Externally, the property benefits from allocated parking, adding to the convenience of this attractive home.

Location wise the property offers the perfect balance between tranquil living and easy access to local amenities (onsite co op shop, restaurant/cafes, nursery and primary school). The bus route

- Modern two-bedroom coach house
- Located in the highly sought-after St Luke's development
- Open-plan lounge, kitchen, and dining area
- French doors leading to a private balcony
- Two bedrooms
- Parking
- Ideal for first-time buyers, professionals, or investors
- Well presented throughout with plenty of natural light
- Convenient access to local amenities, schools, and transport links
- Energy Performance Rating - B

Viewing

Please contact our Sales Office on 01268 730707 if you wish to arrange a viewing appointment for this property or require further information.

 2
  1
  1
  B

Floor Plan

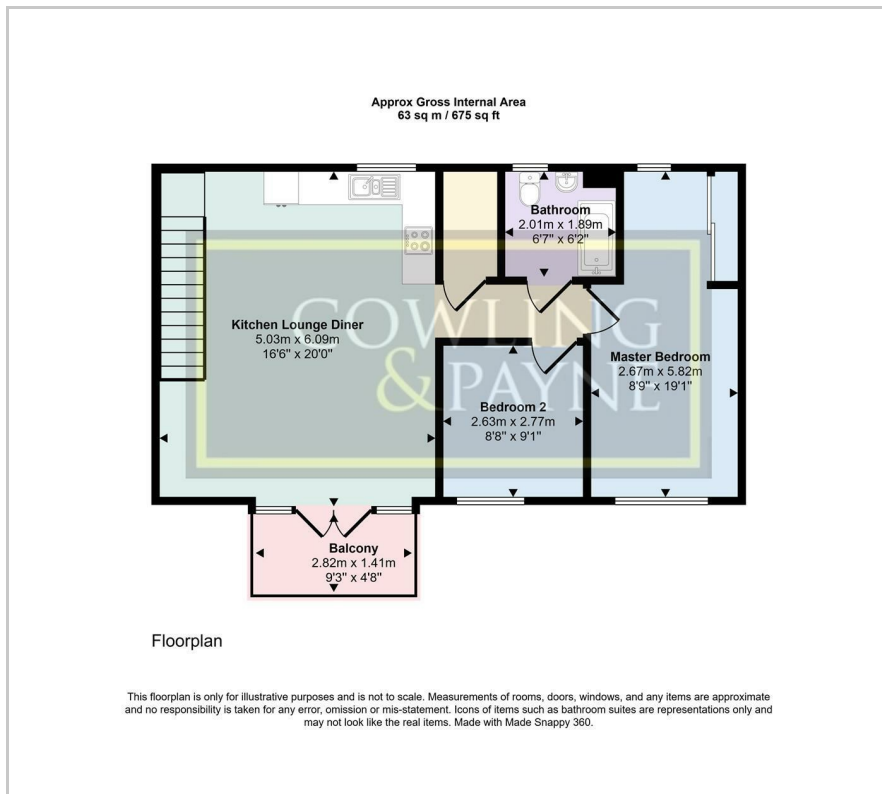

Area Map



Energy Efficiency Graph

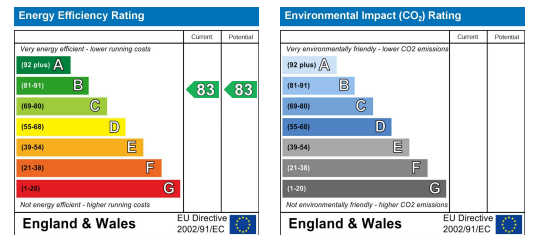

These particulars, whilst believed to be accurate are set out as a general outline only for guidance and do not constitute any part of an offer or contract. Intending purchasers should not rely on them as statements of representation of fact, but must satisfy themselves by inspection or otherwise as to their accuracy. No person in this firms employment has the authority to make or give any representation or warranty in respect of the property.